

Бобышка поз.31 и часть корпуса до вставки и окончательного сверления бобышки Т3
Boss pos.31 and part of shell prior to insertion and final drilling of boss T3

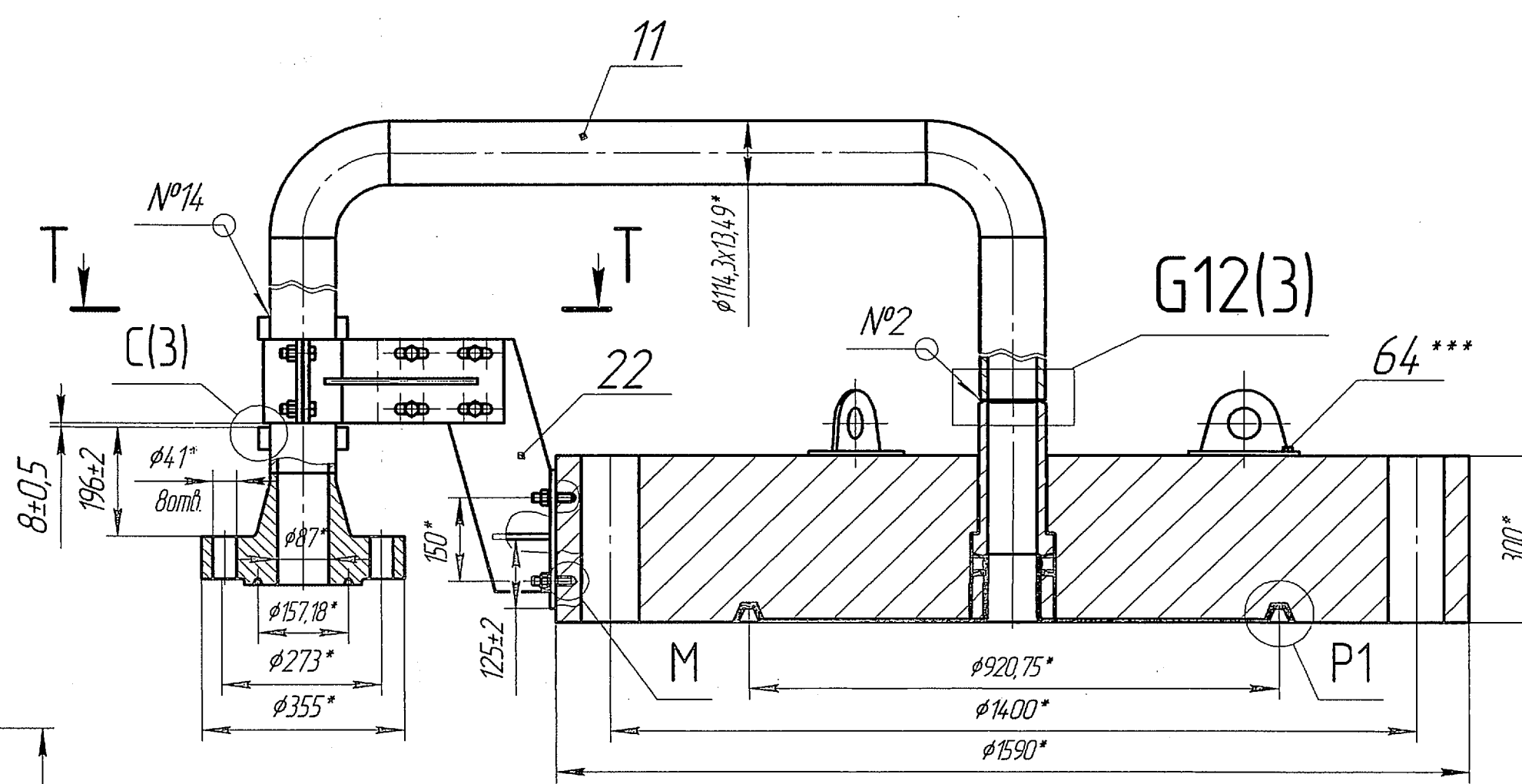

План истинного расположения термодпар
Plan of thermocouples actual location

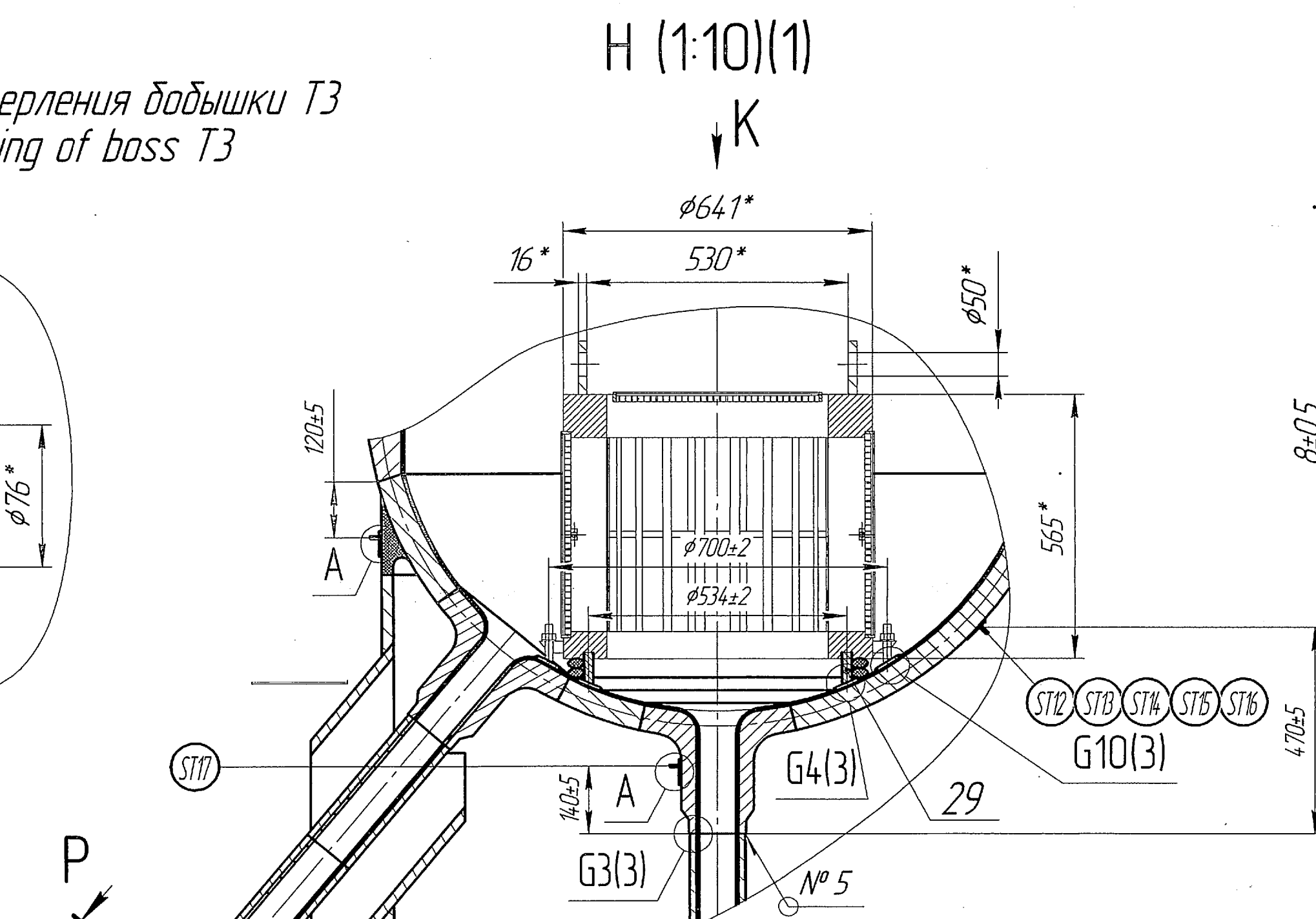
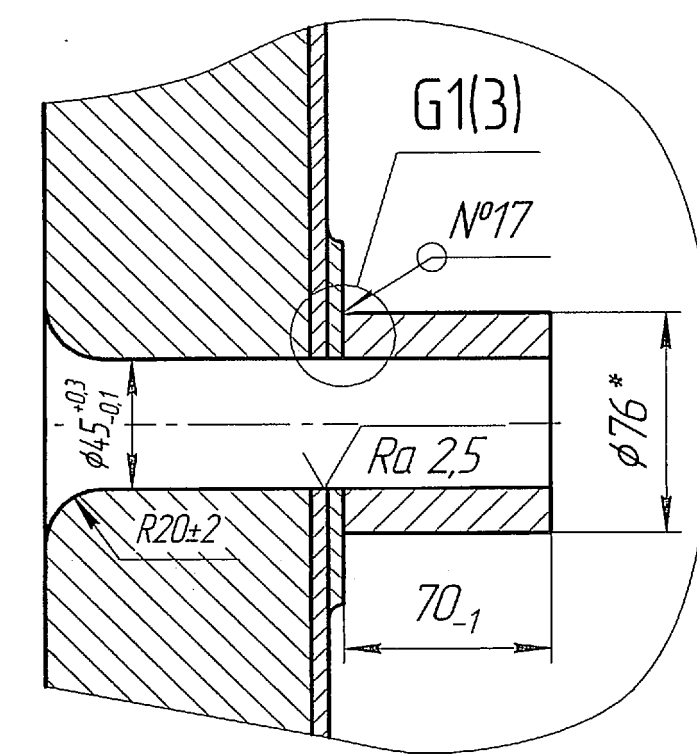
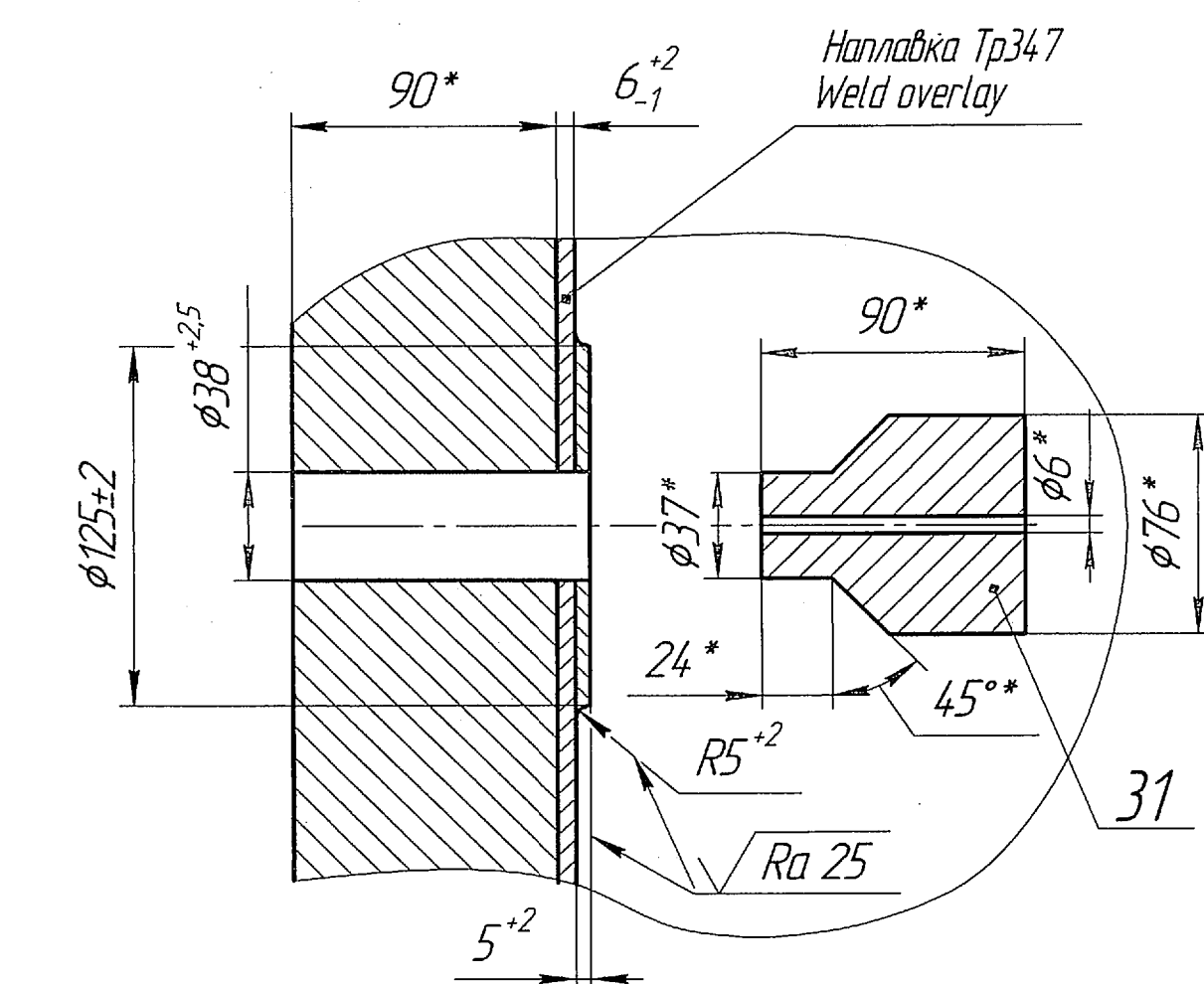
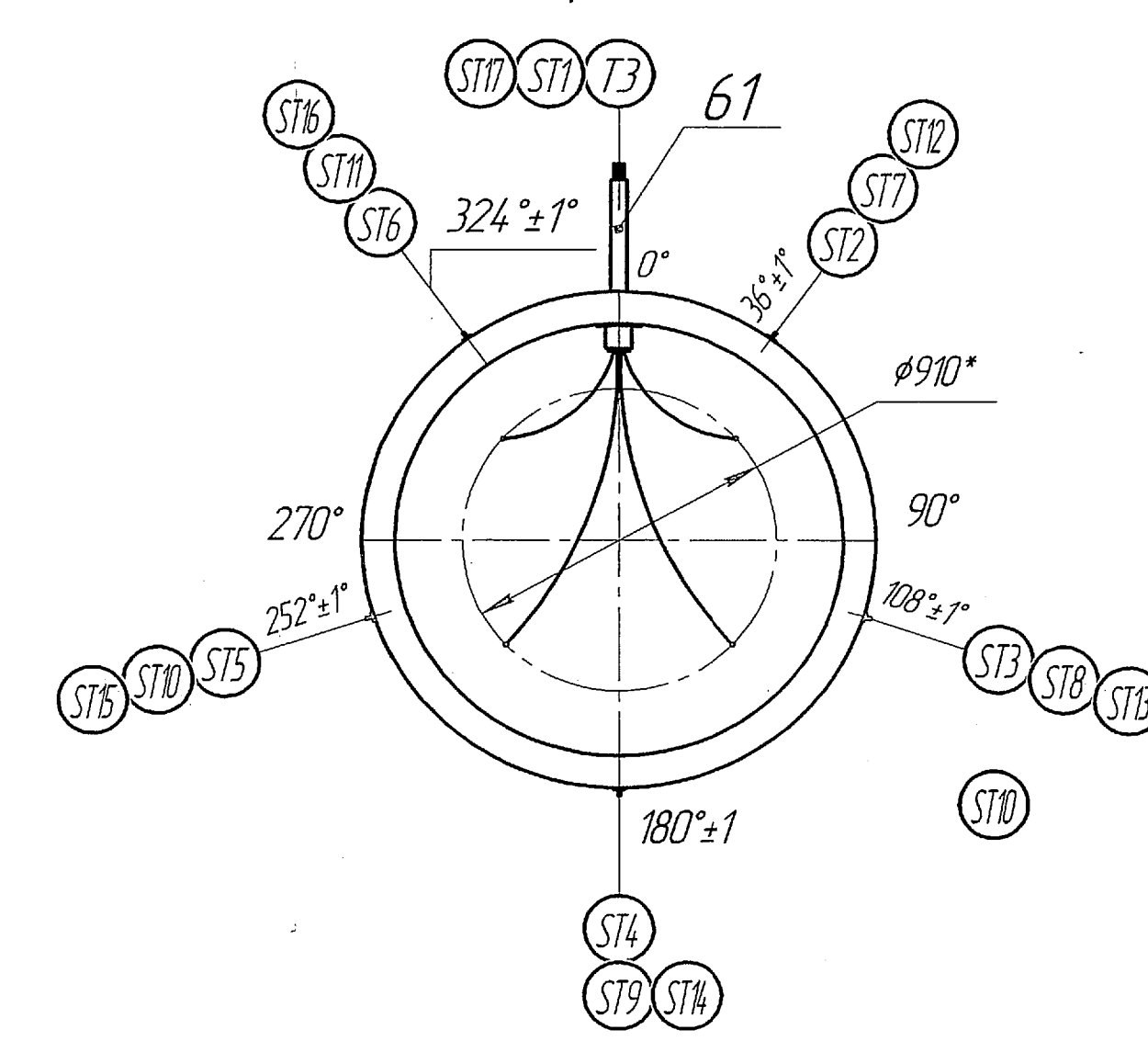

Шаблон опоры поз.72
Template Support

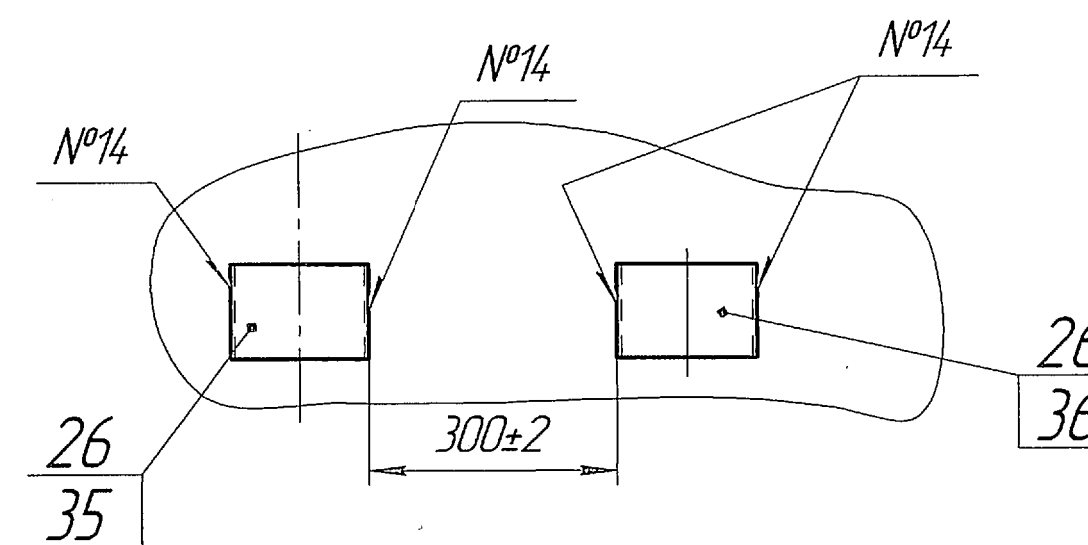
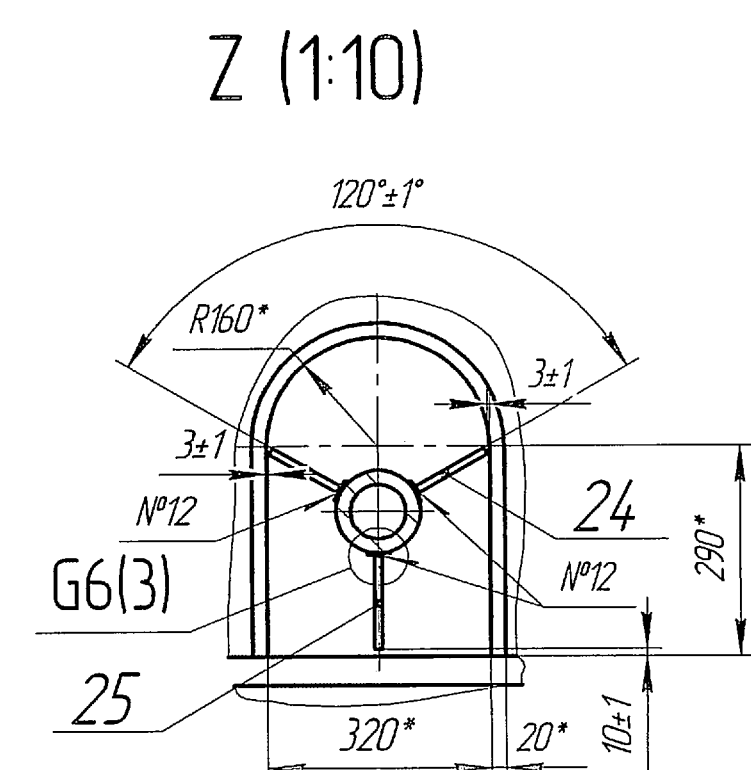
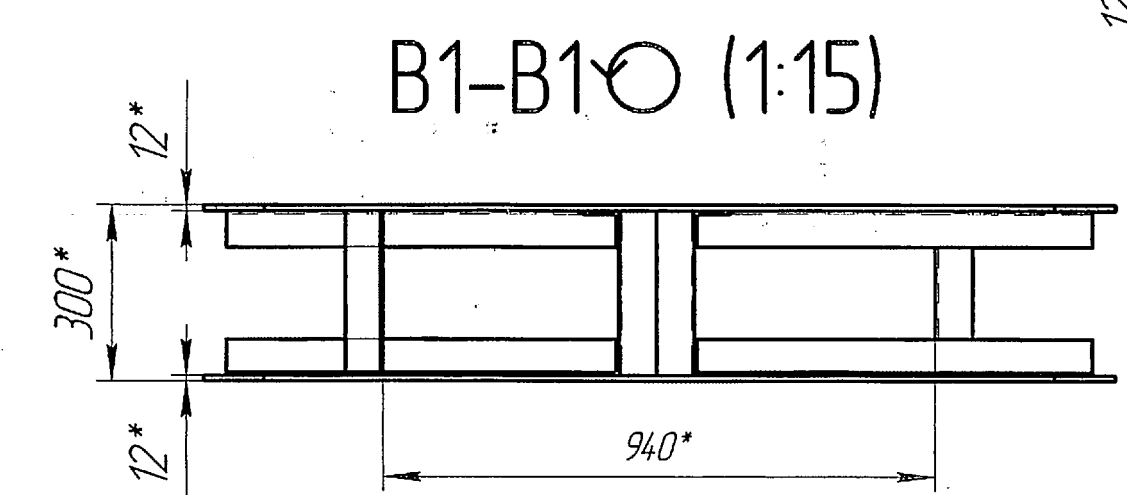
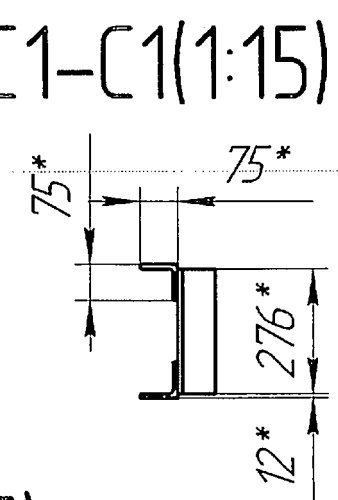
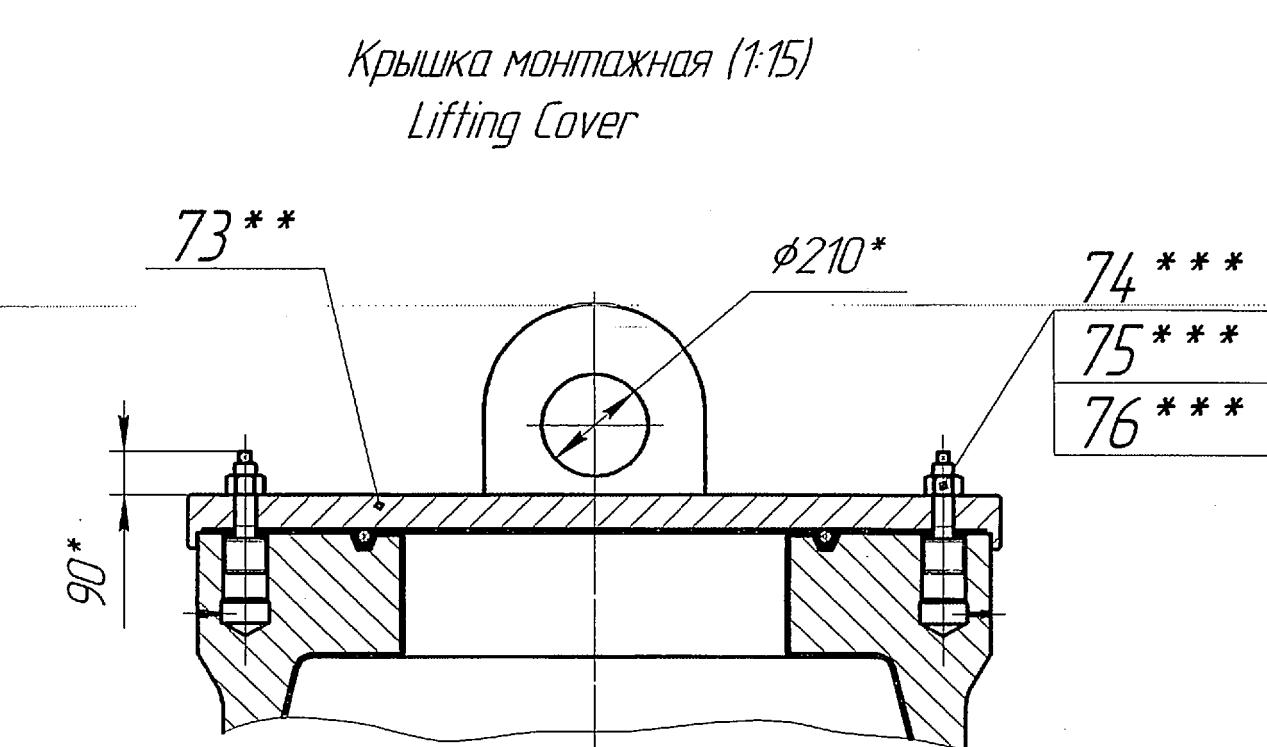
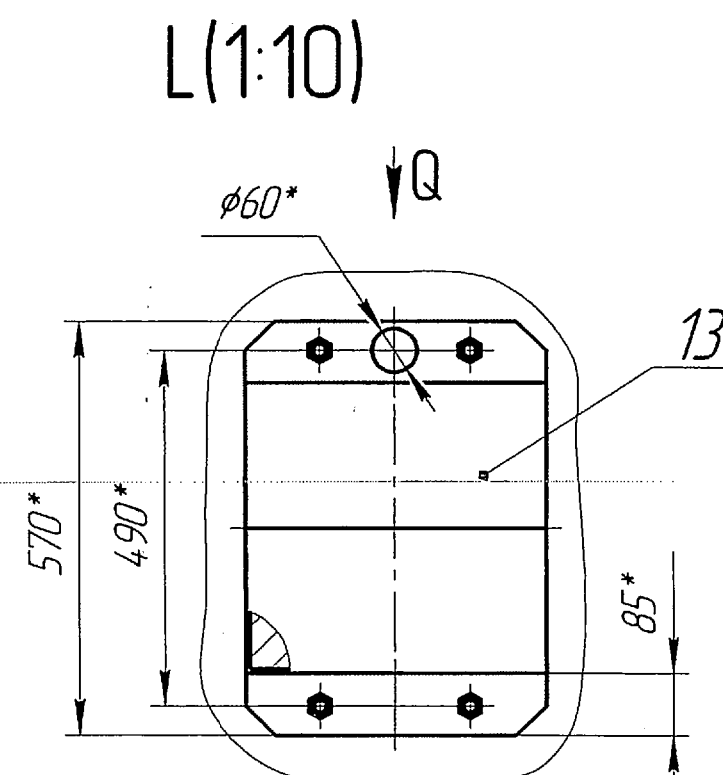
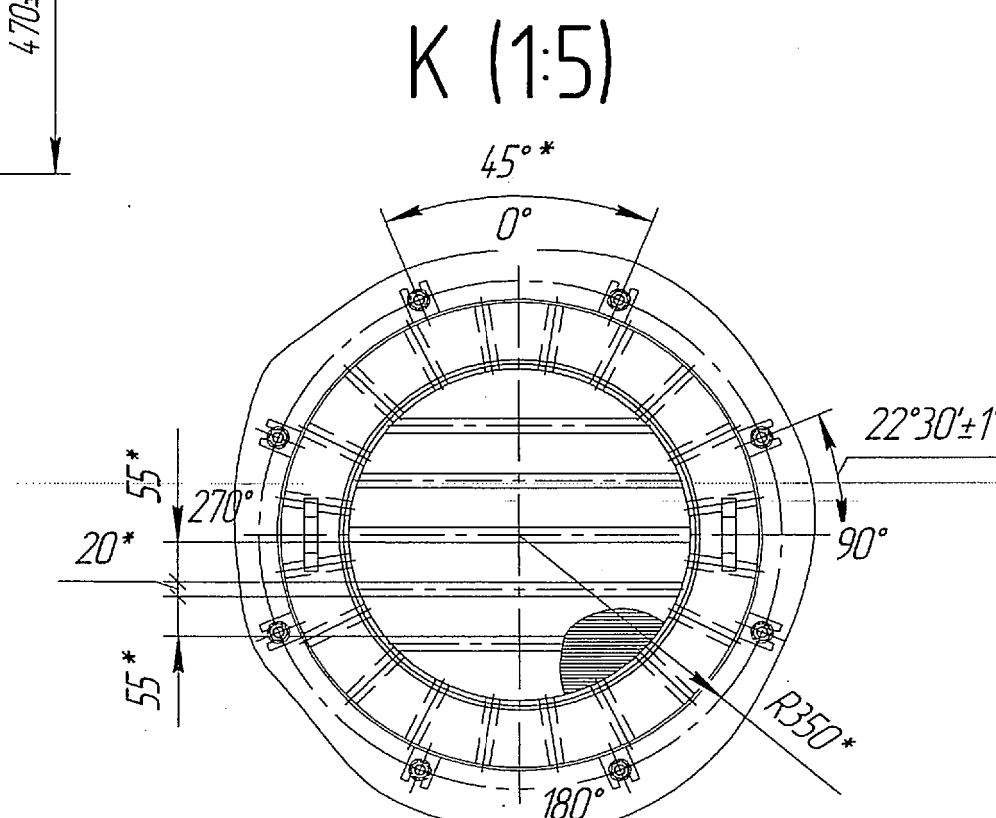
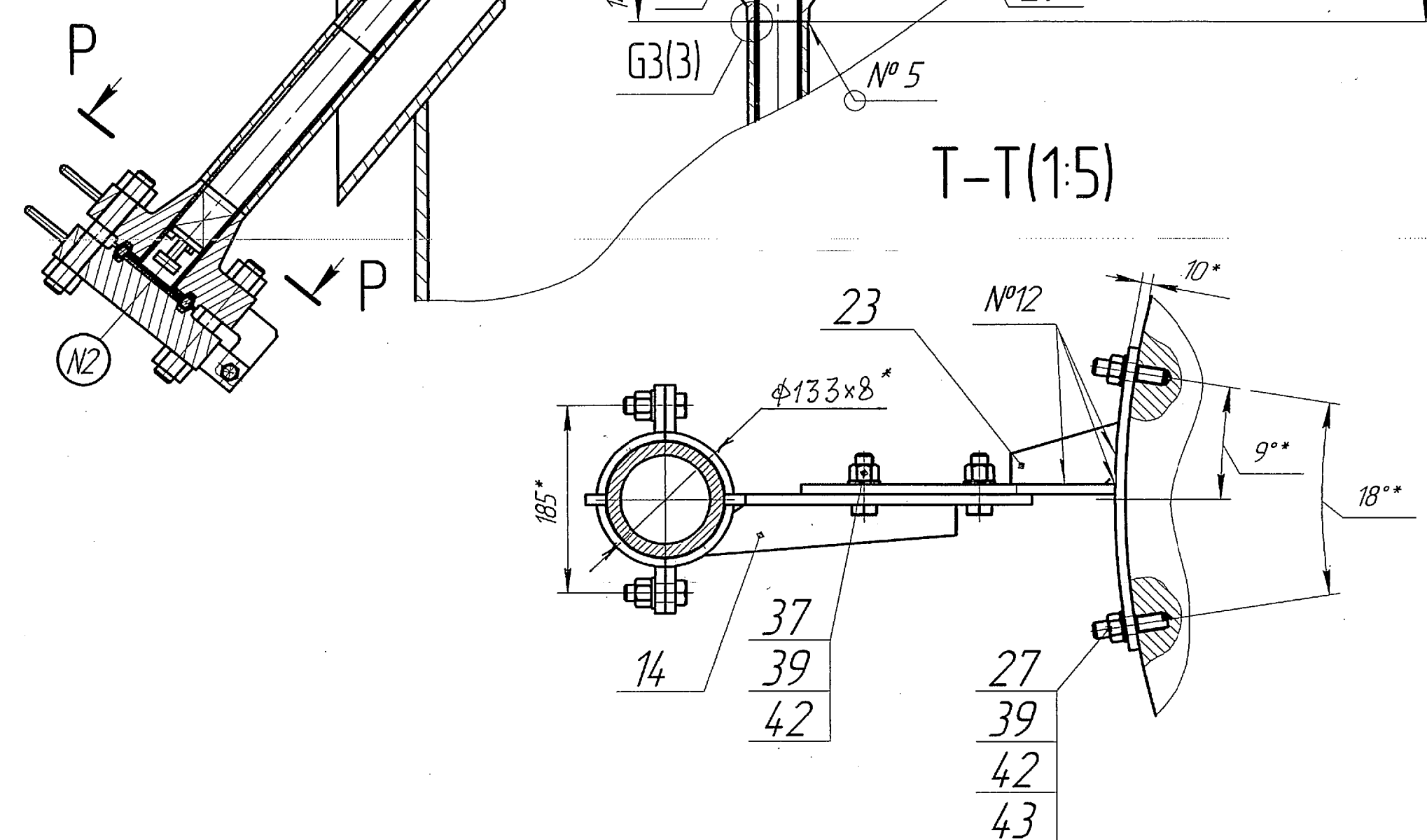
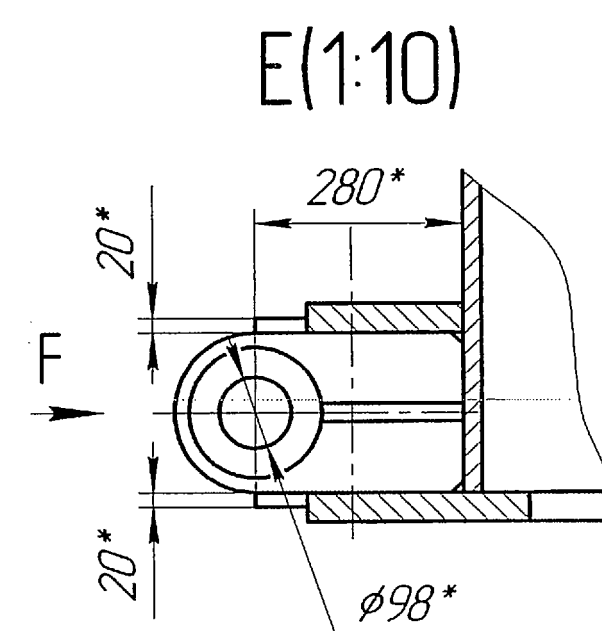
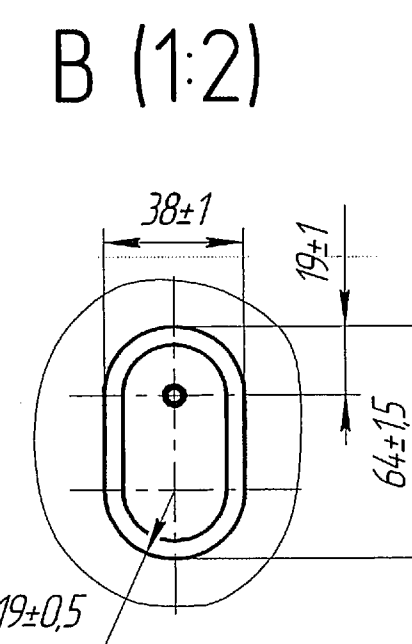
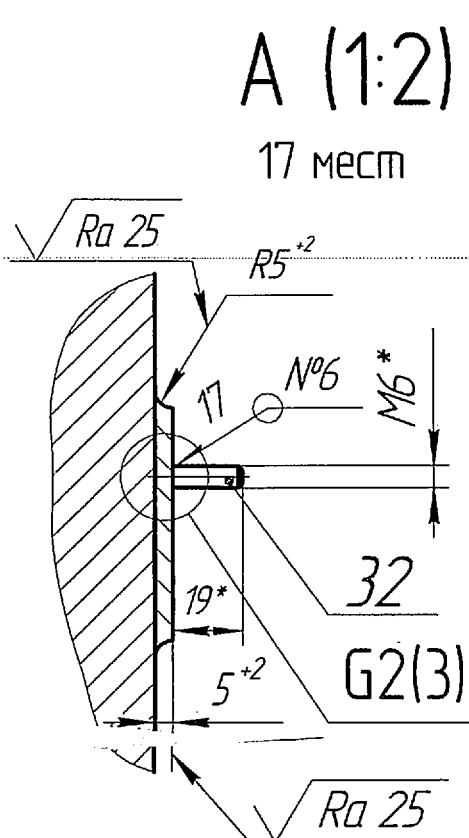
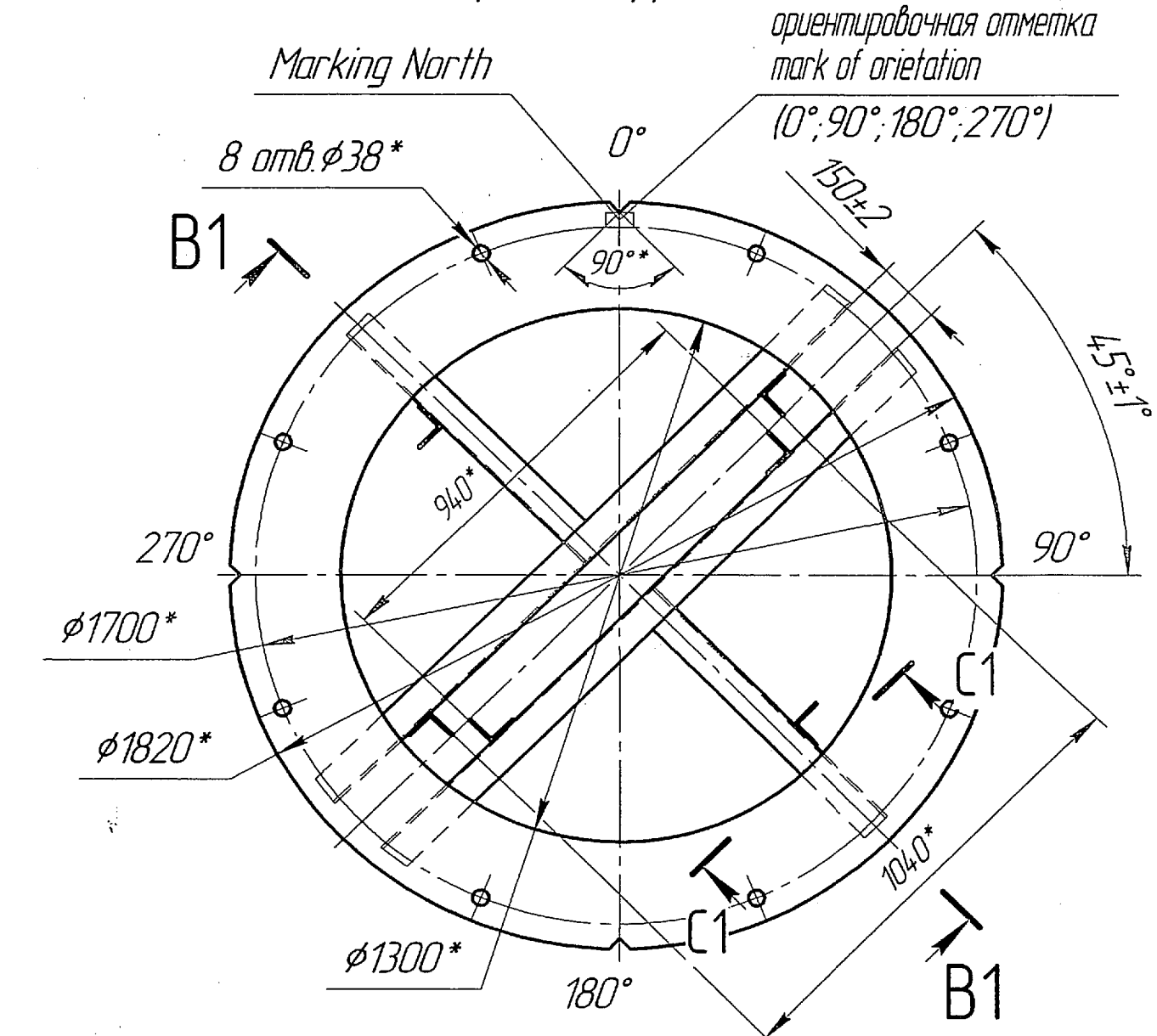

T(1:10)

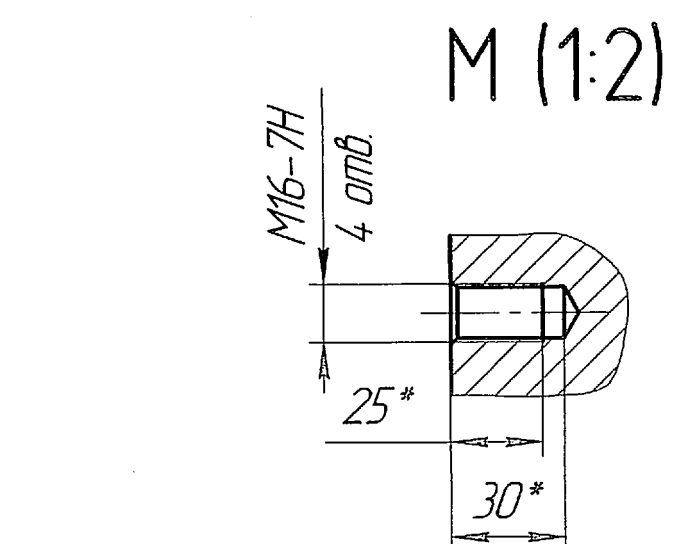
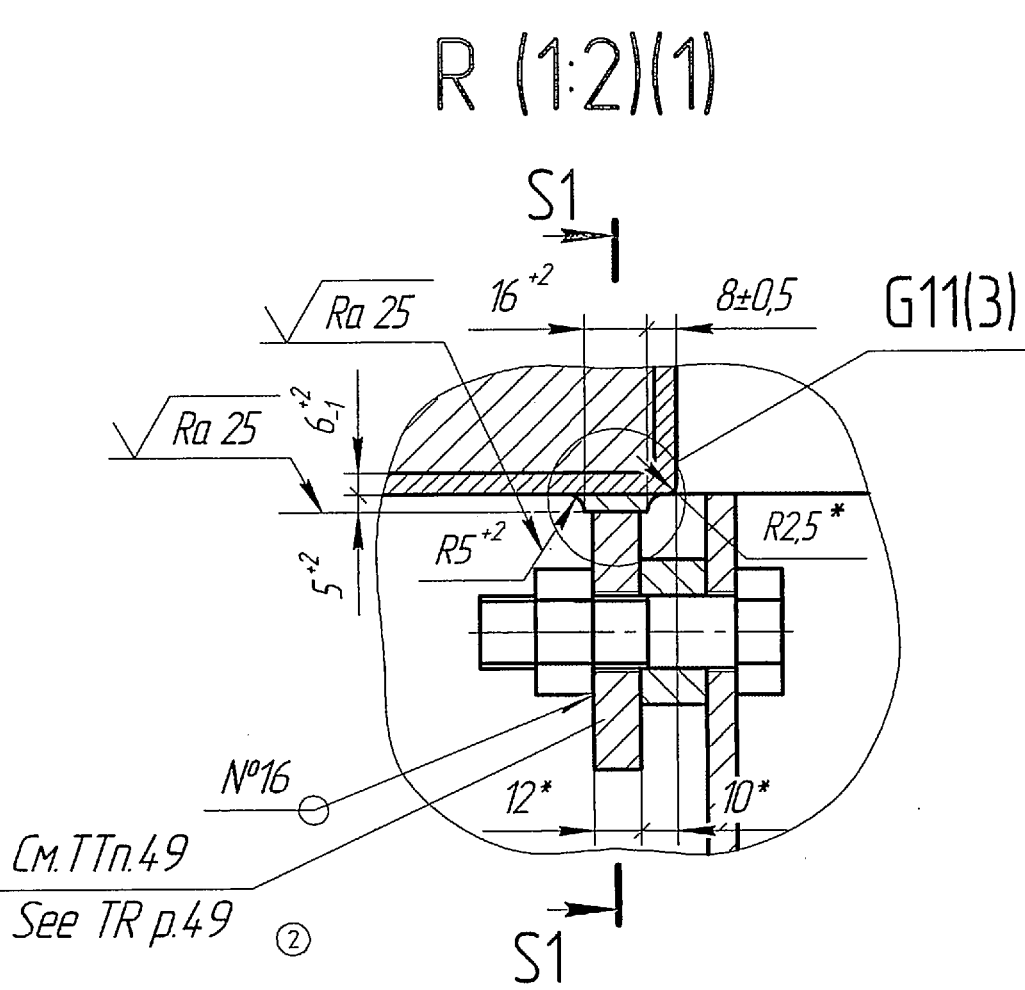
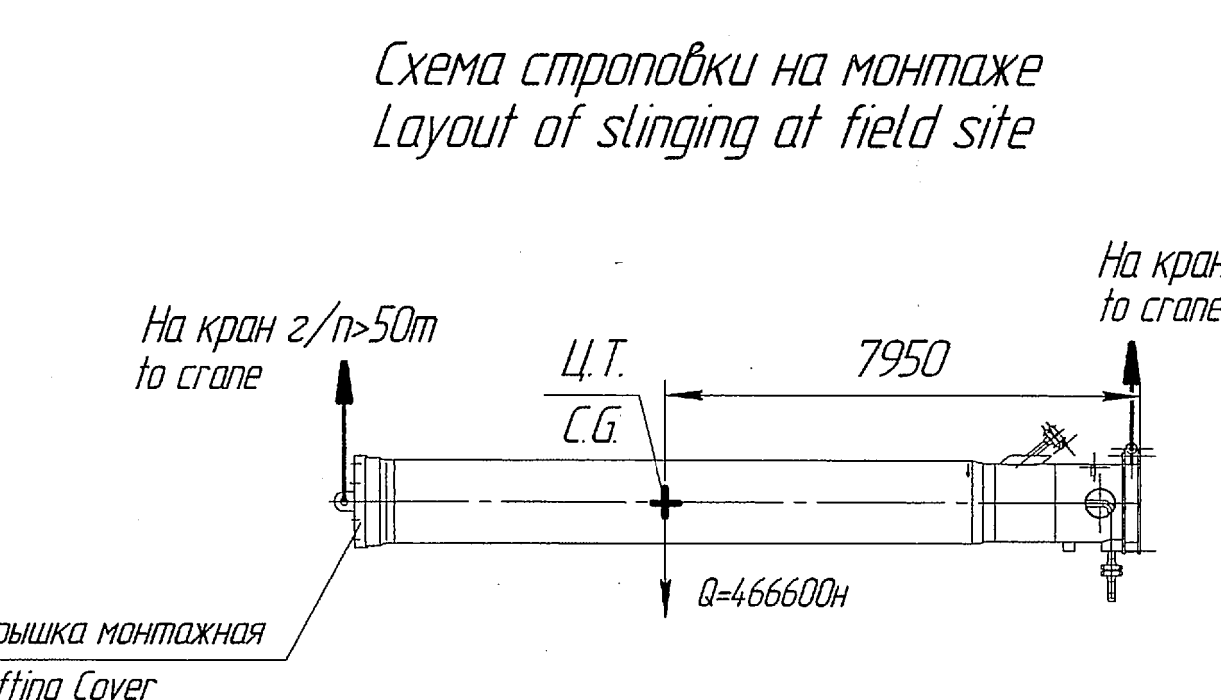
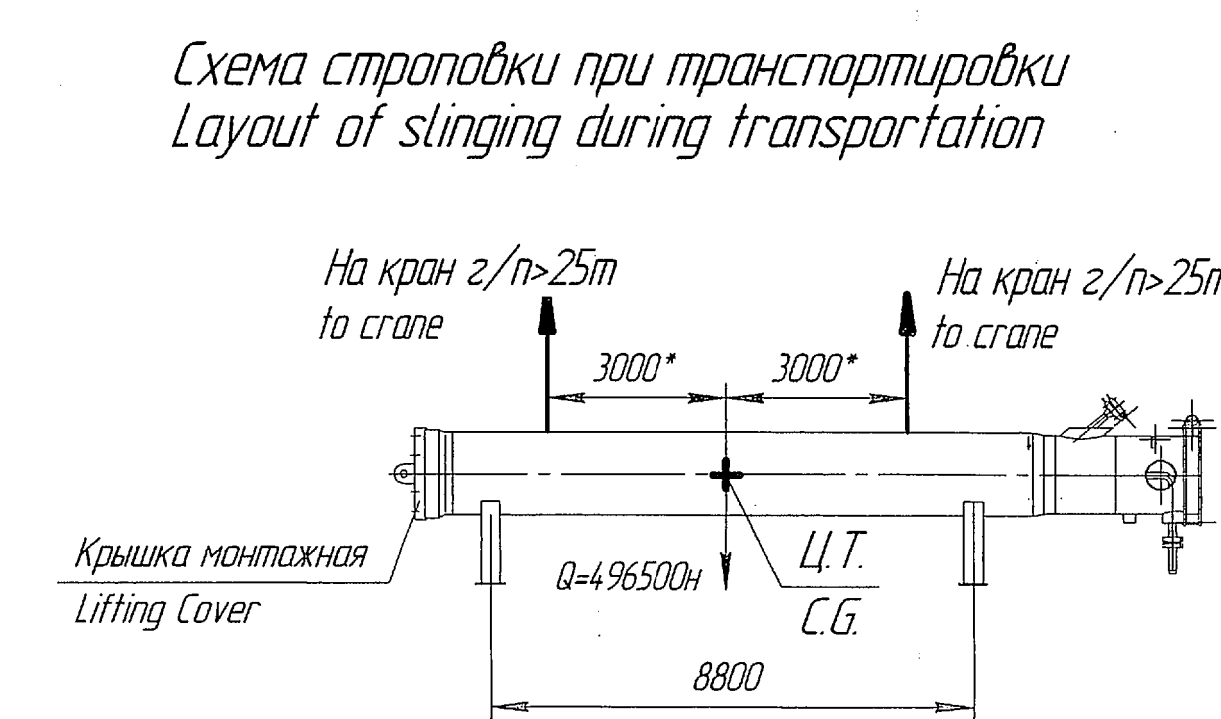
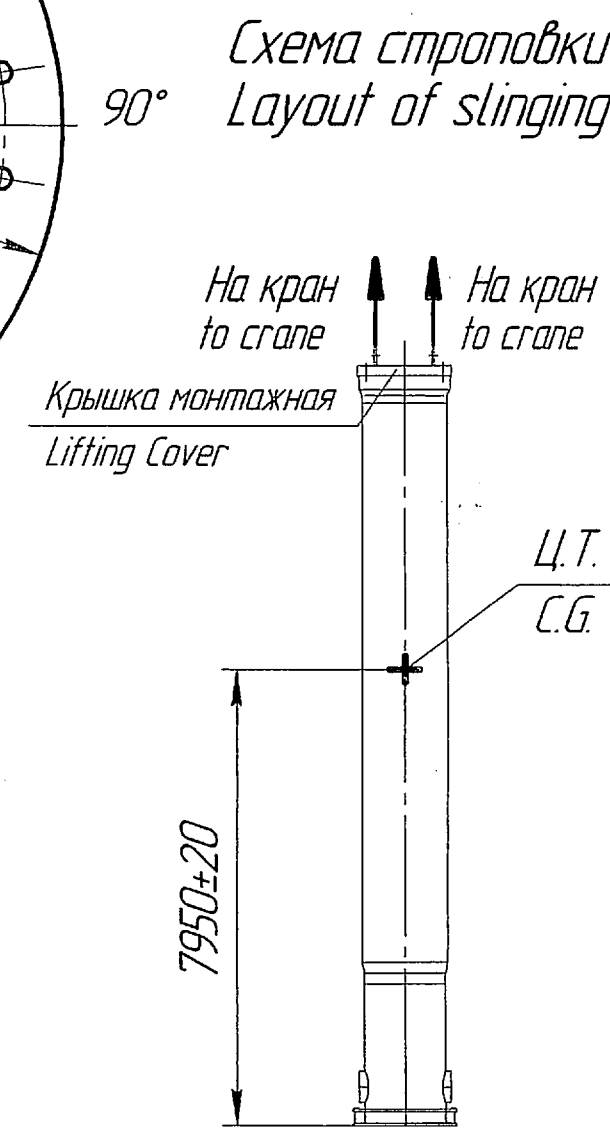
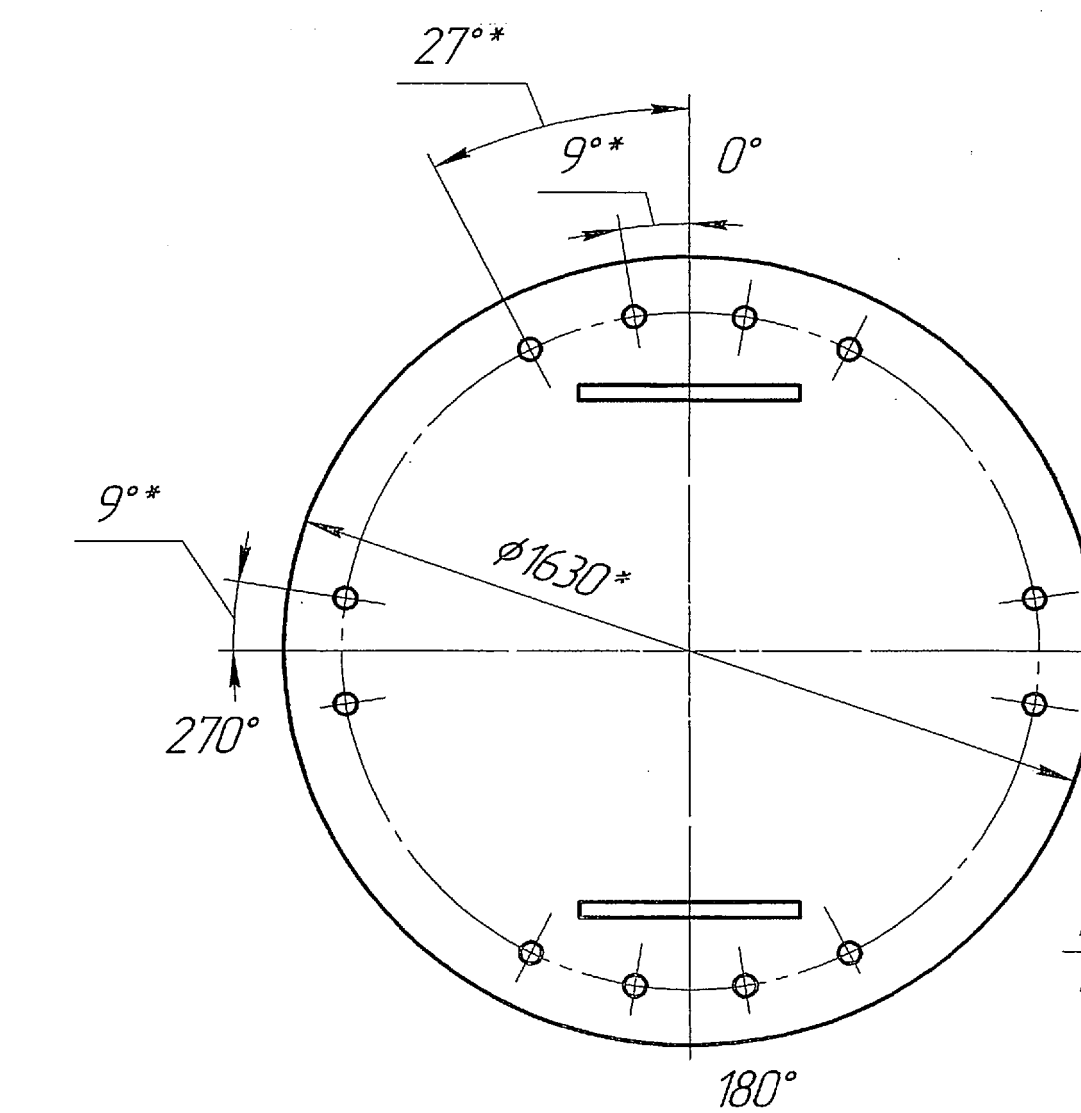
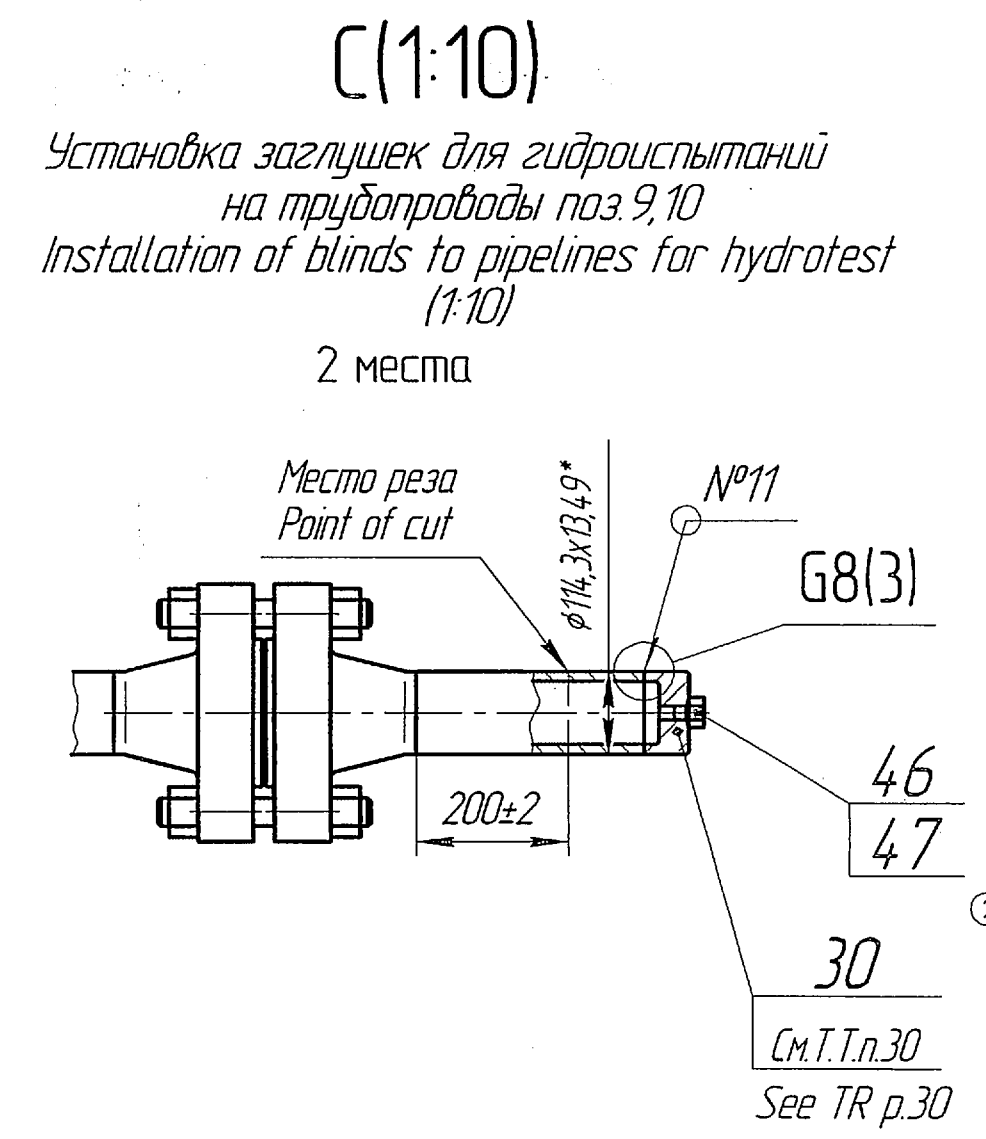
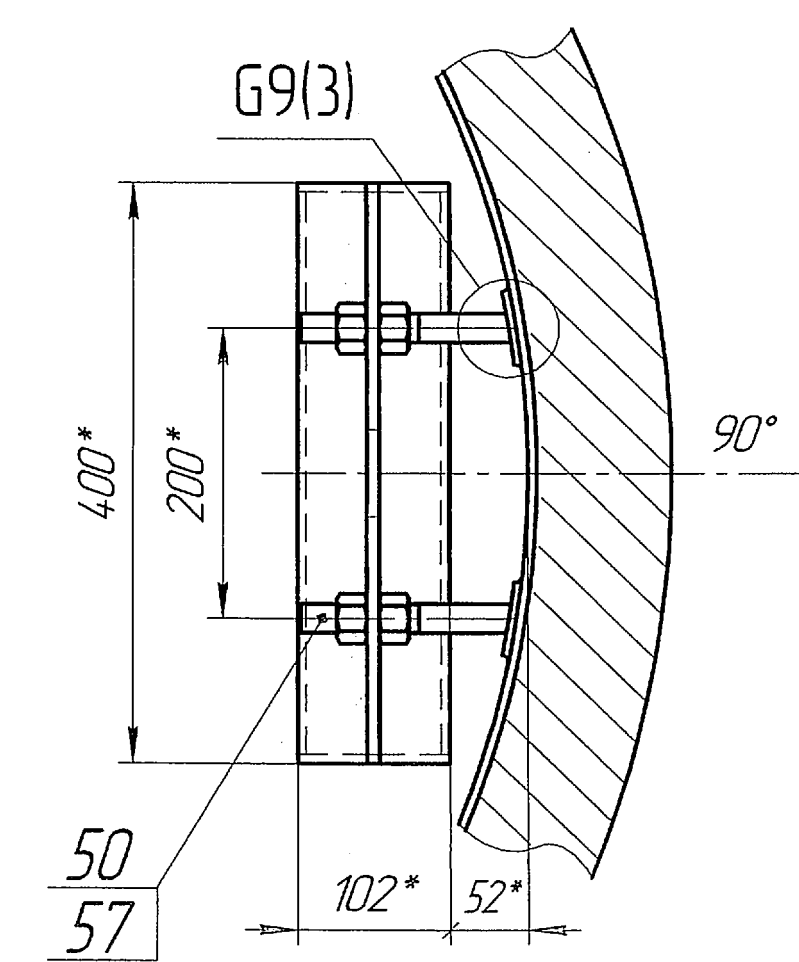
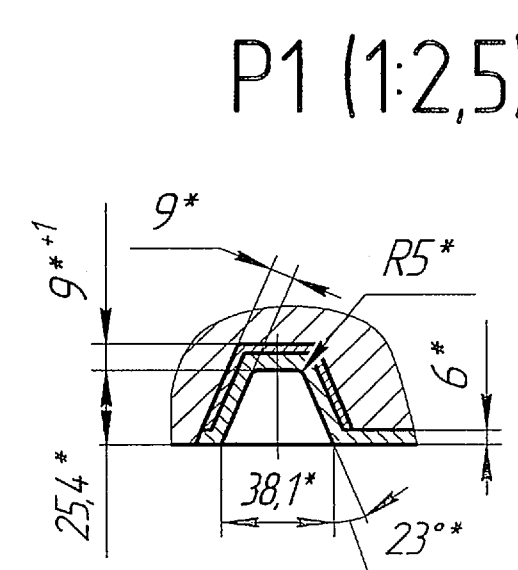
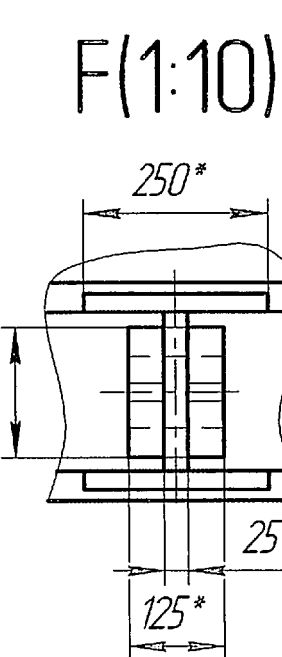
 $Y(1:5)$ 

S1-S1 (1:2)

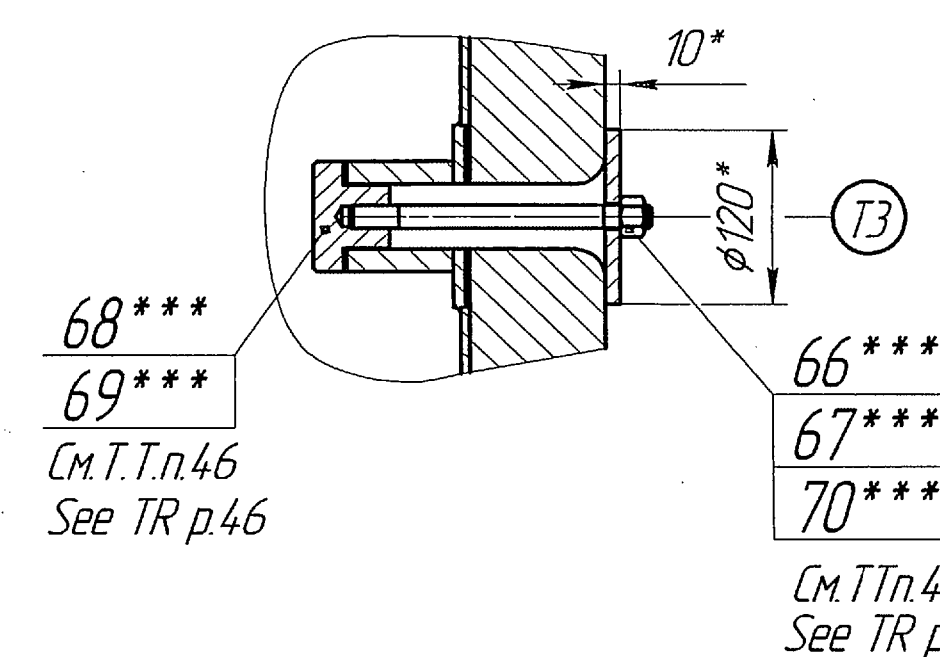
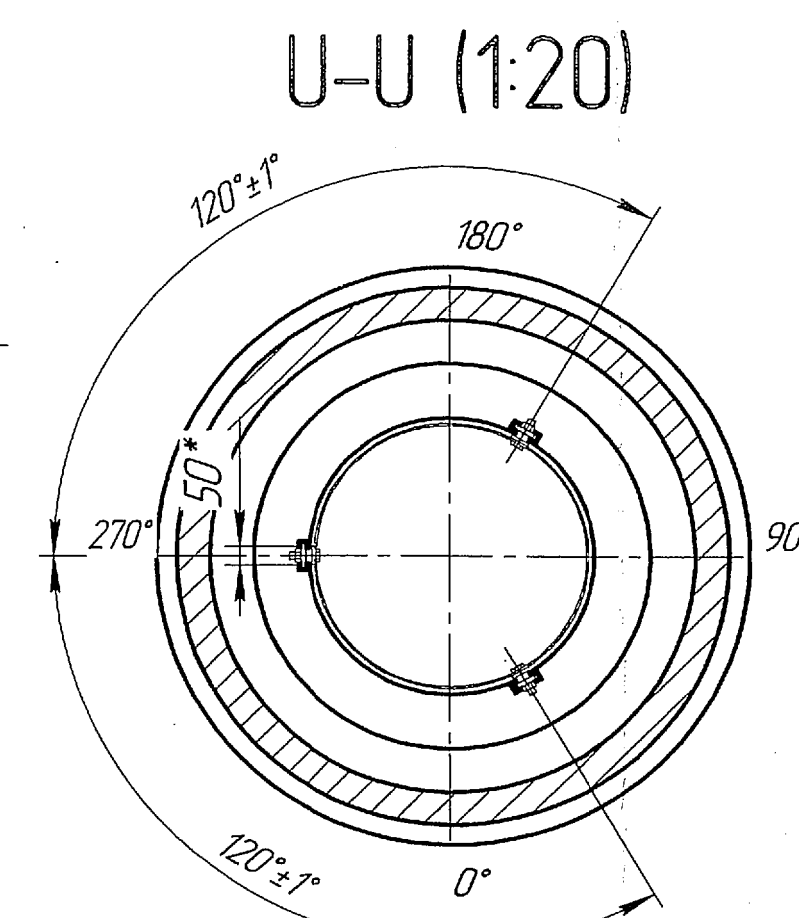
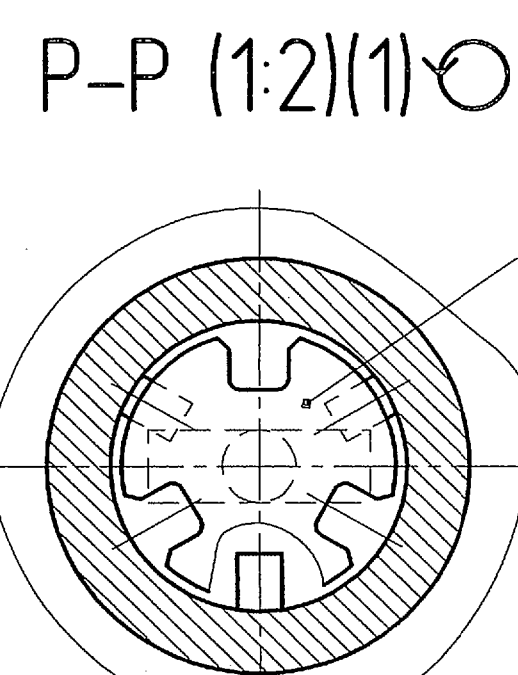
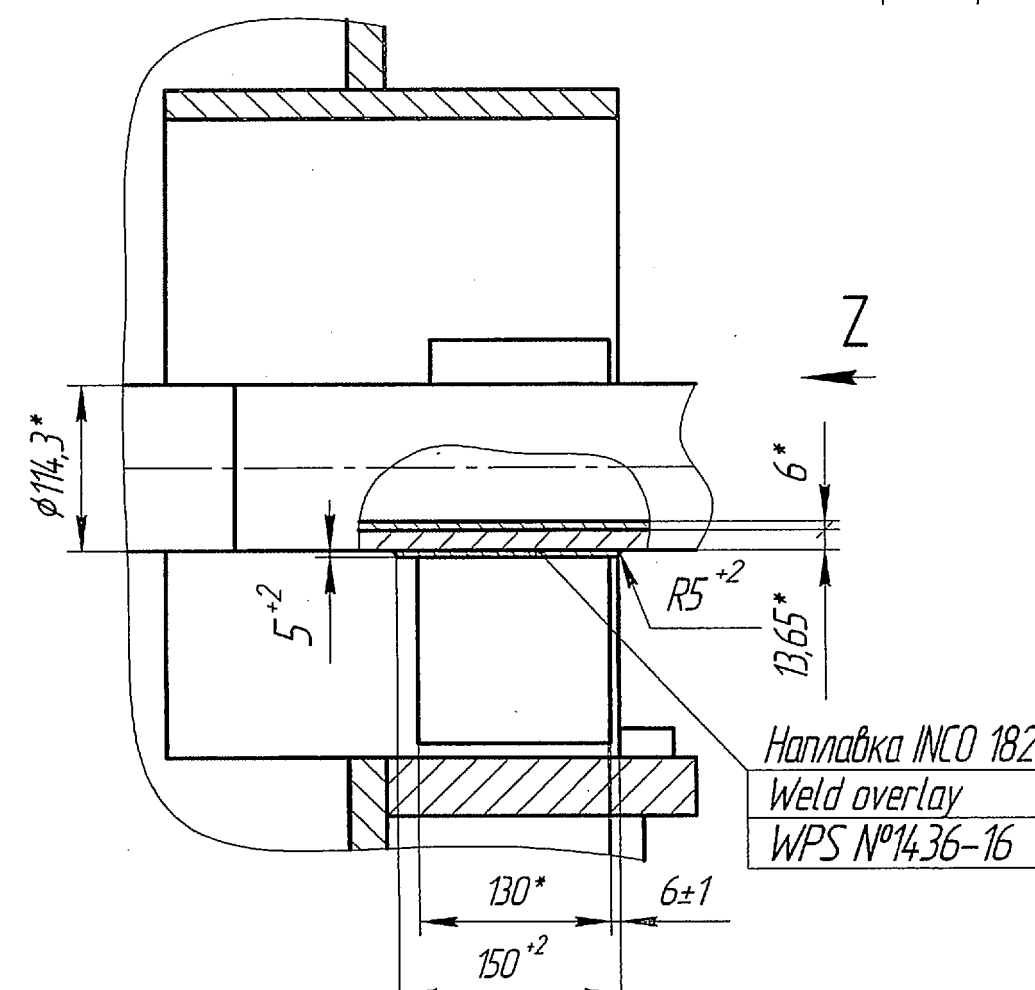

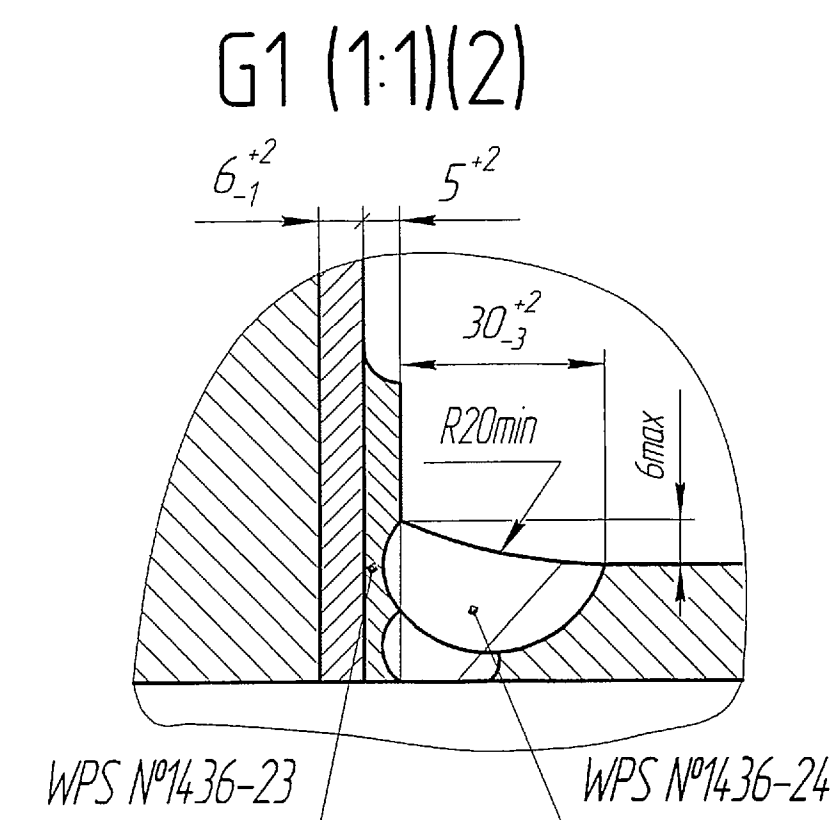

G2(1:1)

17 mecm
points

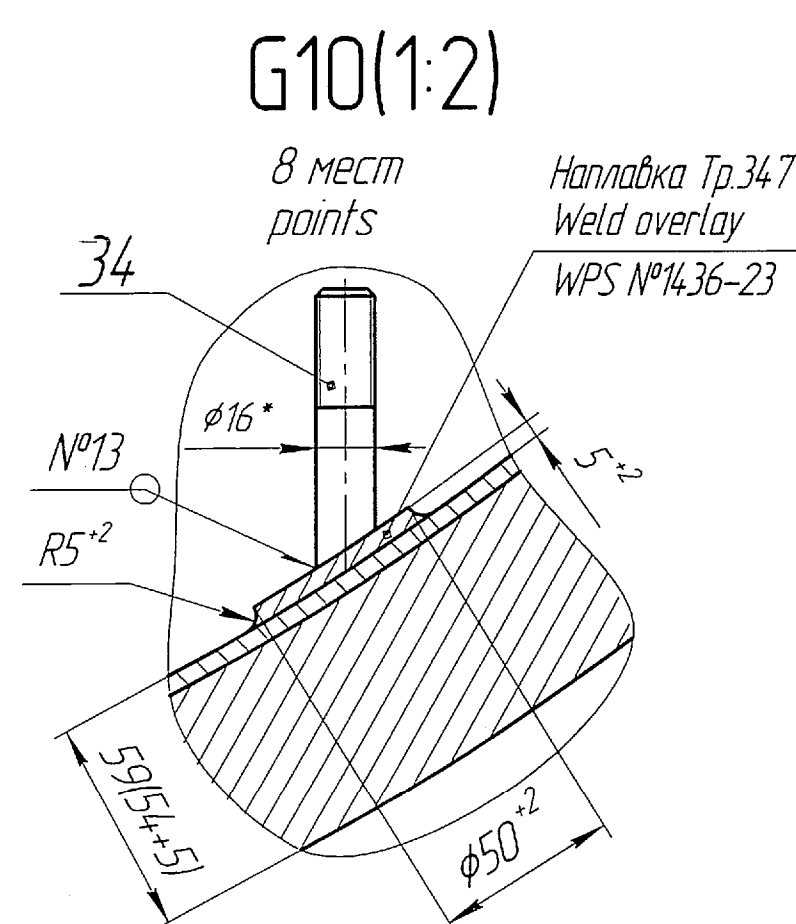
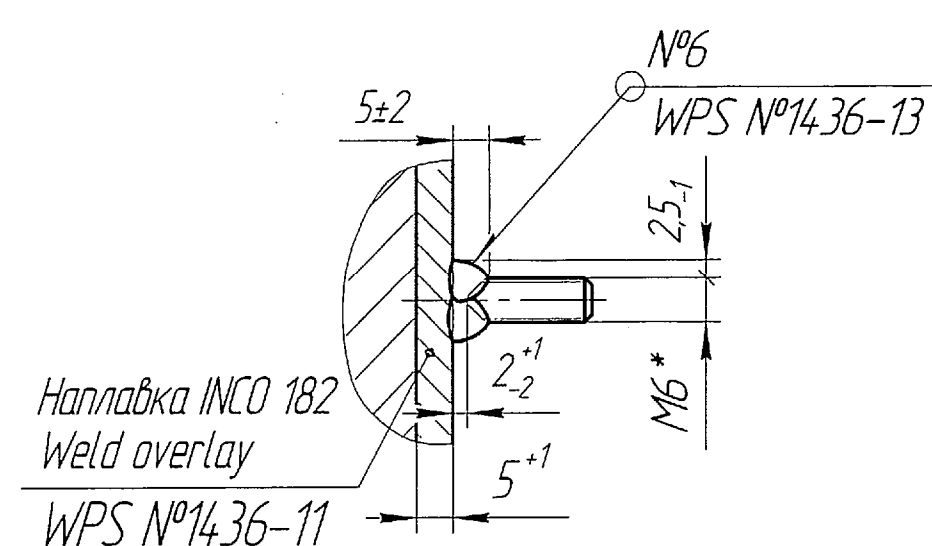

G7(1:1)

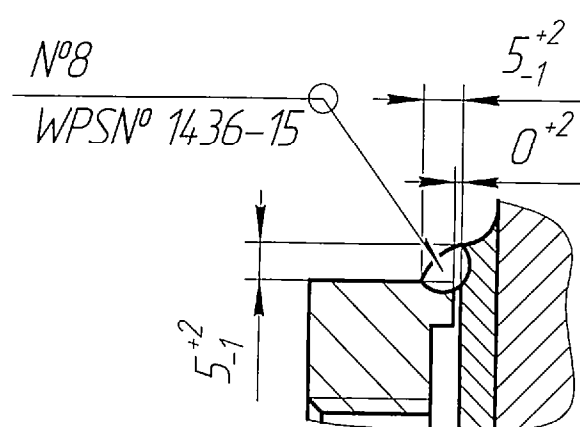
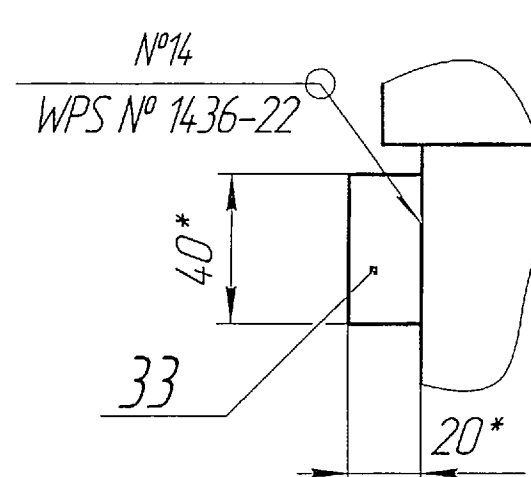
 $C(1:2)$ 

G5(1:2)

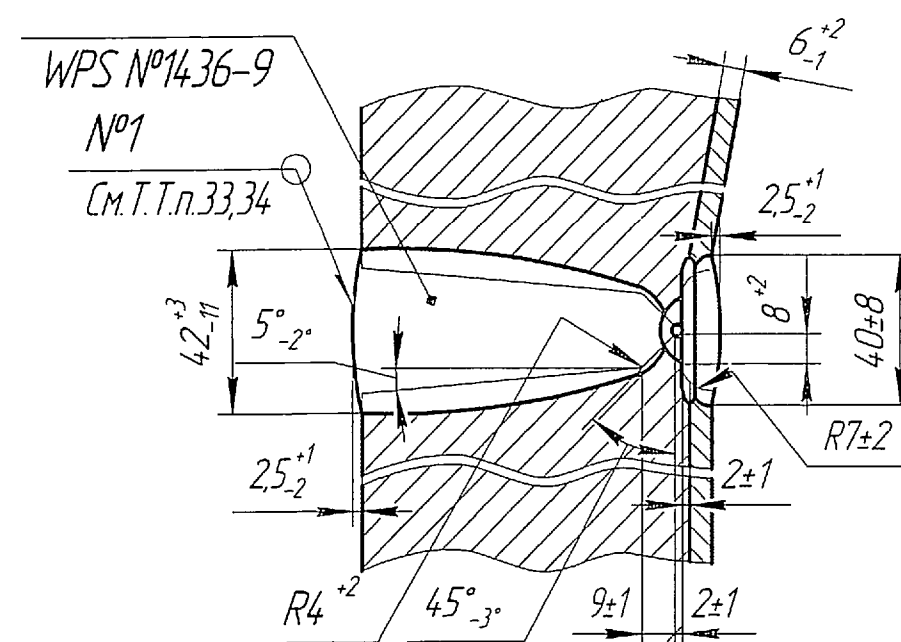

G6(1:1)

3 meema
points

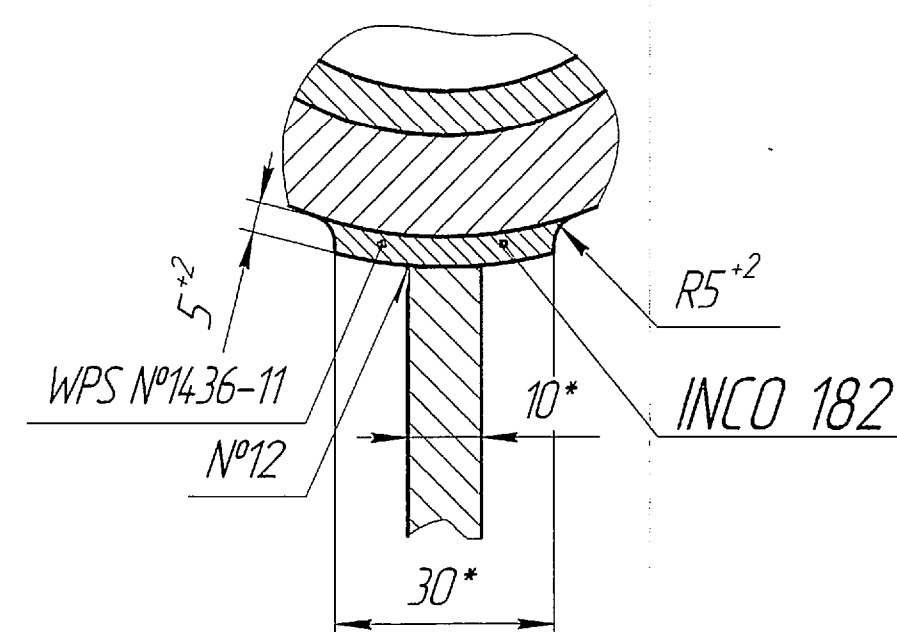

W-W (1:2)(1)

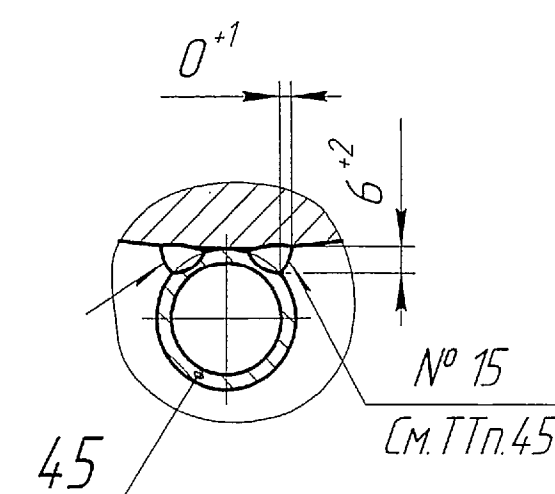

G3(2:1)

Приварка трубы к напудку штыцера N1
Welding of pipe to nozzle N1

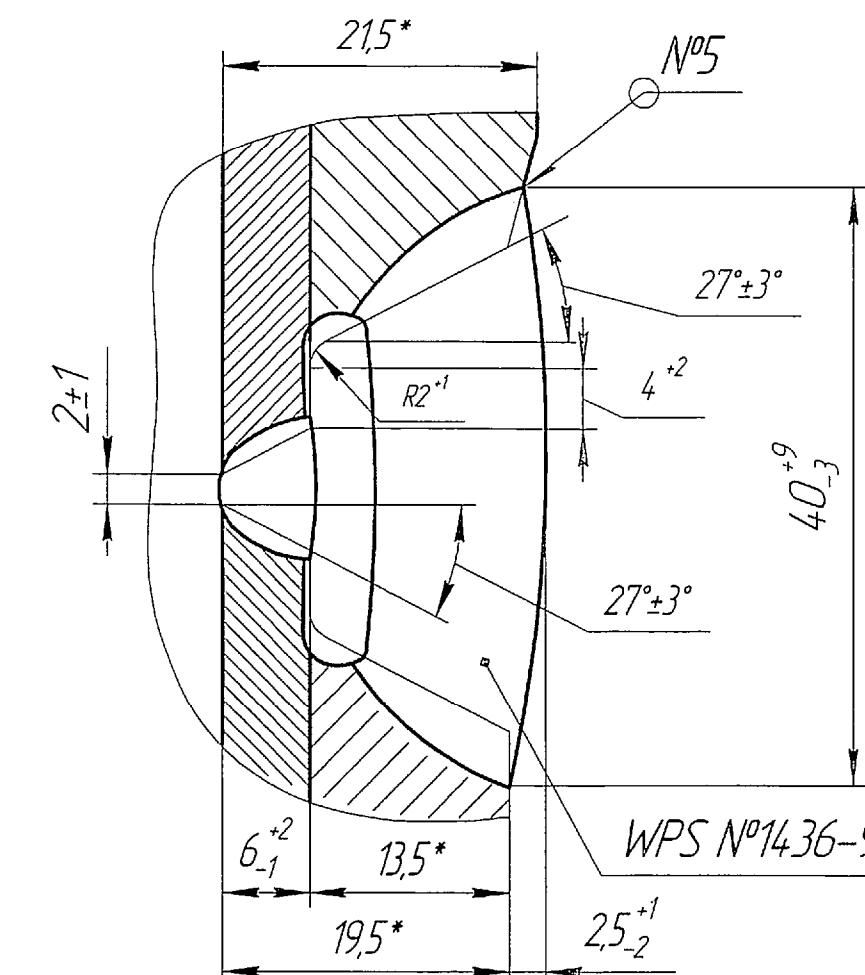

Наплавка под опорное кольцо к корпусу
Weld overlay to shell for support ring
(1:2)

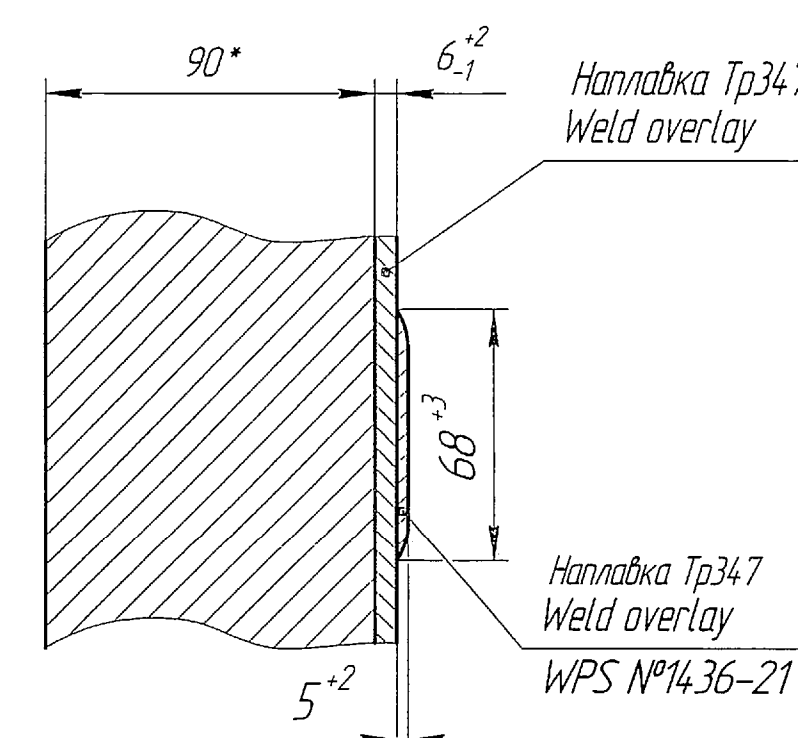

G9(1:2)

4 meclizine
pills

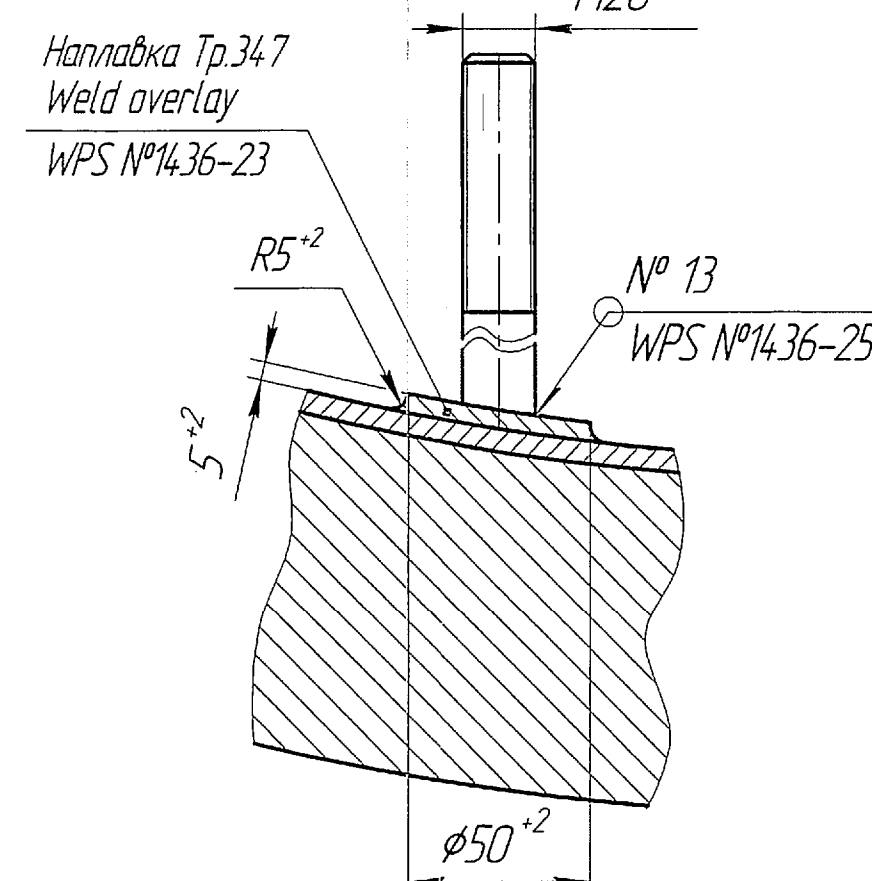

G4(1:2)

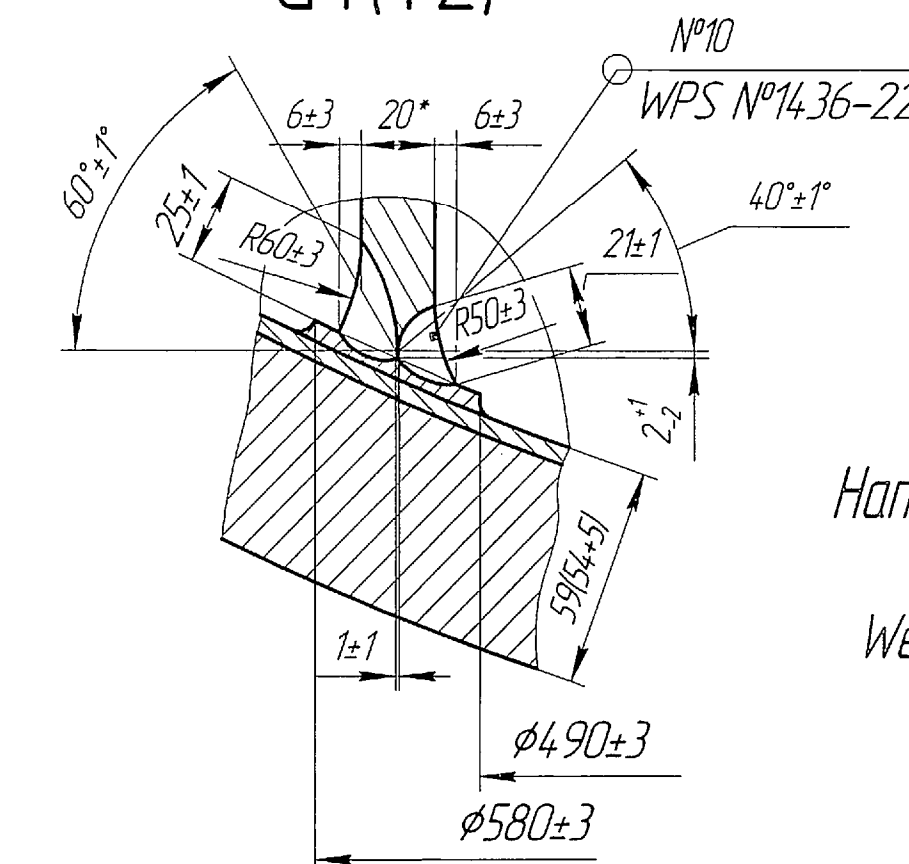

G11(1:2)

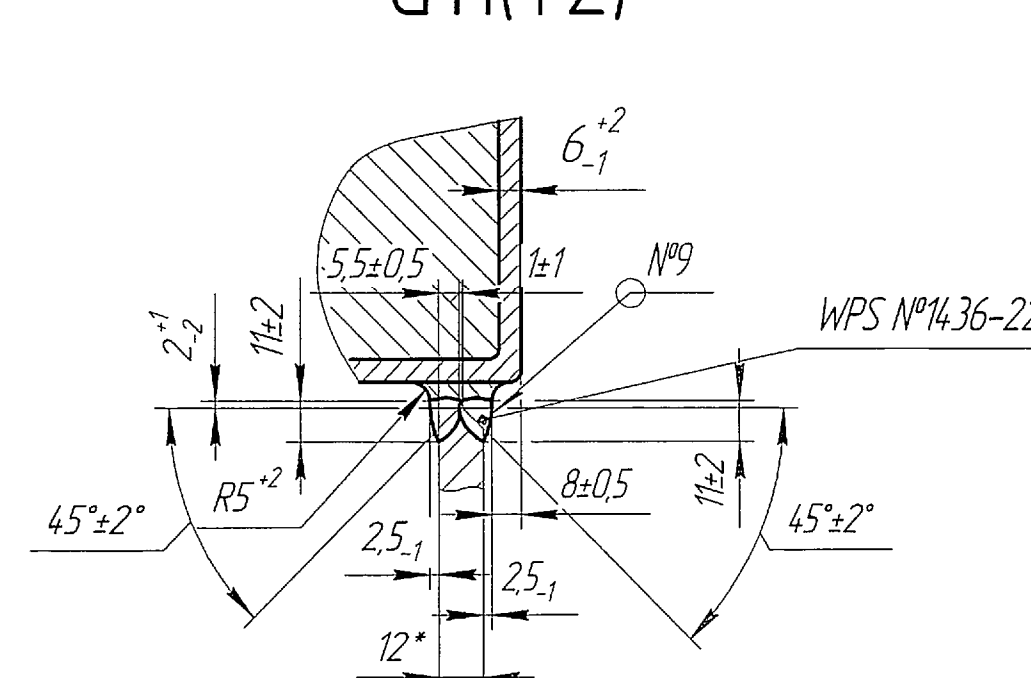
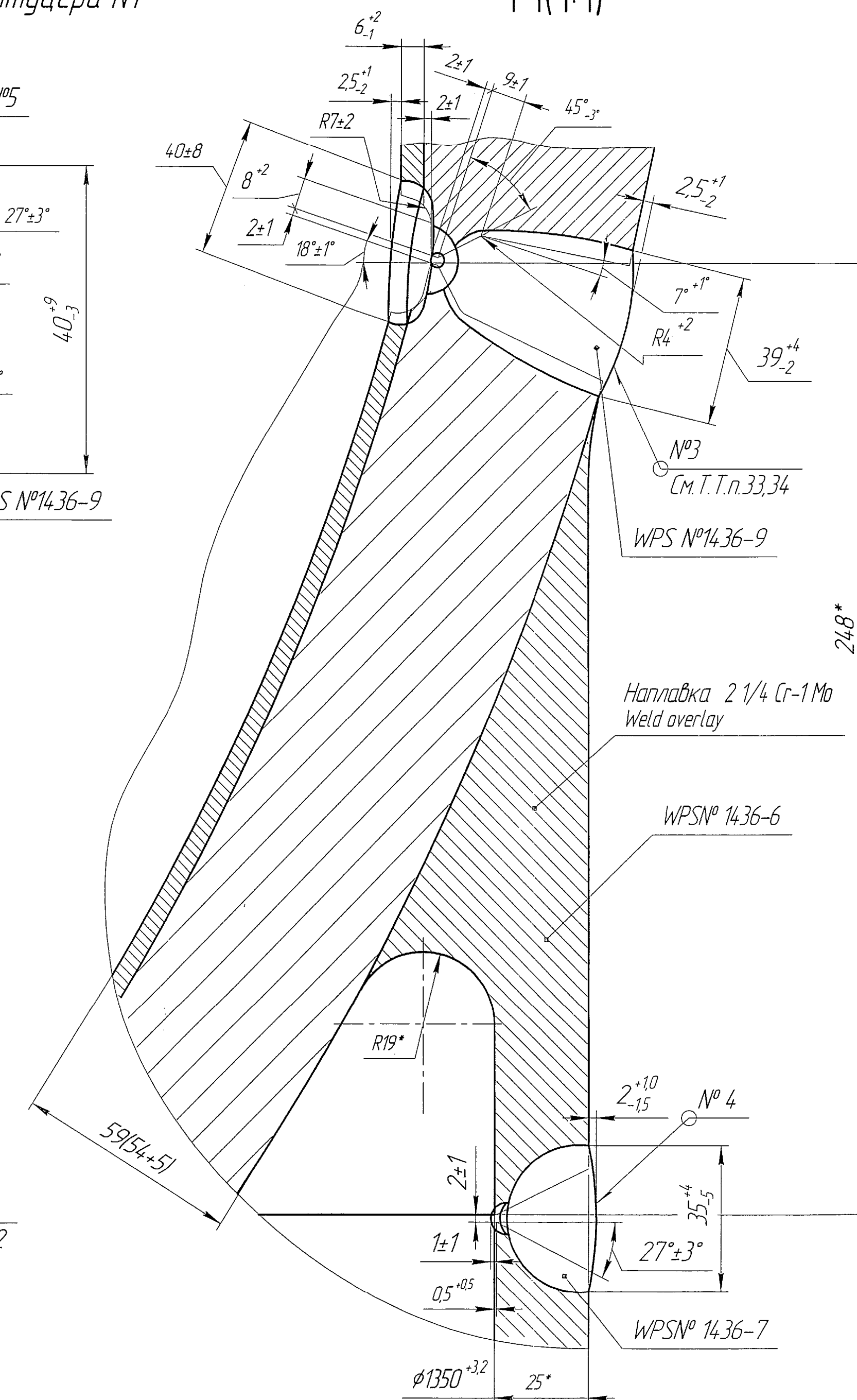
$$Y1(1:1)$$

Q1(1:2)(1)

Приварка опорного кольца к корпусу
Welding of support ring to shell

